



Wide 4.3 inch Color Chartplotter / DGPS, SBAS(WAAS/EGNOS)

Model: HGP-430



C-MAP & HY Chart

Compact Design

Daylight View

◆ Display

Wide 4.3 inch color TFT LCD high-contrast bright(350cd/m²) for optimum viewing under direct sunlight

◆ Three Chart Systems

Three chart systems(C-MAP/Built-in/HY Chart) are available. The most suitable chart are selected by the user. Lots of information such as buoys, lighthouses, wrecks and tides are provided.

◆ High speed zoom-in & zoom-out

The Fastest processor is built in. Zoom-in and zoom-out are the fastest than any other chartplotters in the world.

◆ Various Modes

- Chartplotter
- Full screen
- Highway
- Steering Mode

◆ Multi-language

Selection of languages, Korean, English, Italian, Chinese, Taiwanese, Vietnamese, Arabic, Thai, Greek, Turkish, Malay, Arabic, Indian(Urdu, Gujarati,Hindi), Persian etc.

◆ XD Card

XD Card is available for the back-up of user data (WPTs, marks, routes, tracks, etc), upgrade of new program and the HY chart of the system.

◆ High Accuracy

- Support of high accuracy
- DGPS
- WAAS
- EGNOS

◆ Waterproof

Display suited for flybridge installation



103-903 Bucheon Technopark 364 Samcheongdong Ojeonggu

Bucheon Gyeonggi, Korea

TEL : +82 2 324 0381

FAX : +82 32 327 4713

Web-site : <http://www.haiyang.co.kr>

GENERAL SPECIFICATION

1. Display Screen
4.3 inch(wide) color TFT LCD(480 X 272 pixels)
2. Display Brightness
350cd/m²
3. Operating Temperature
Display Unit -15°C ~ 50°C
Antenna Unit -25°C ~ 70°C
4. Performance Standard
IMO Resolution MSC.112(73)
5. Back-up
XD Picture Card (Optional)
6. Optional
HAIYANG Chart with XD Picture Card

GPS RECEIVER SPECIFICATION

1. Receive Type
L1 frequency(1575.42MHz), C/A code
2. Number of Channel
16 channels
3. Accuracy
Position 2.5m CEP
DGPS/SBAS 2.0m CEP
4. Sensitivity
Acquisition -140 dBm
Tracking -149 dBm
5. Data Update Rate
1 Second
6. Support
DGPS, SBAS (WAAS, EGNOS)

CHARTPLOTTER SPECIFICATION

1. Display Method Mercado Projection
2. Display Mode
True motion / North up / Course up / Head up
3. Latitude Limits Between 85° N to 85° S
4. Map Scale 0.05nm to 500nm
5. Map Datum WGS-84(Standard), 270 different Datums
6. Waypoint 5,000 points
7. Event Mark 10,000 points
*Total of 16 colors and 16 icons are selectable each point with name tag (8 alphanumeric characters)
8. Track Point 50,000 points
9. Route Max capacity 100 Routes
*20 WPTs per each Route. Each with name tags (8 alphanumeric characters)
10. Draw Point 1,000 points
11. Area Name 1,000 points
12. Chart Data Built-in/C-MAP/HY Chart(XD Card)
13. Output Data NMEA-0183
14. Input Data NMEA-0183
15. Alarm Arrival, Anchor, Off course, Interval timer

Interconnection Diagram

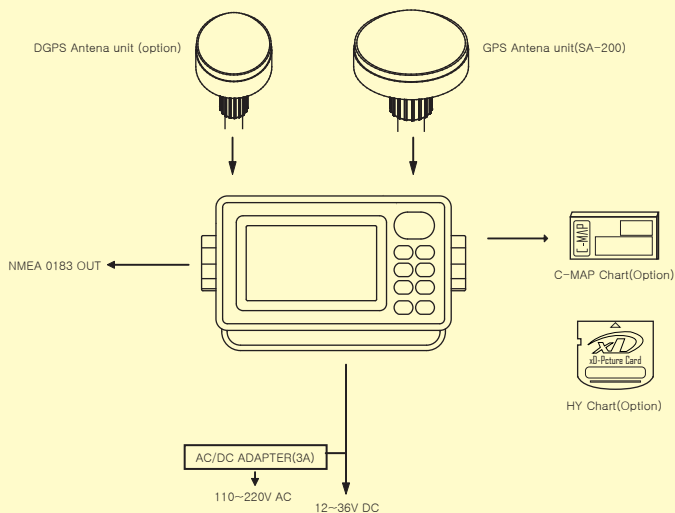

Display Unit

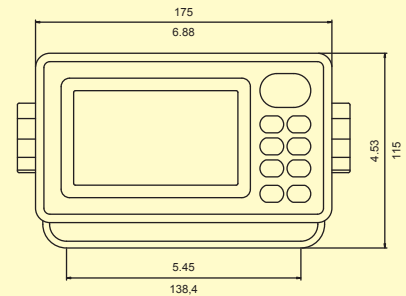

<Front>

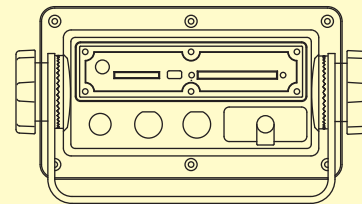

<Rear>

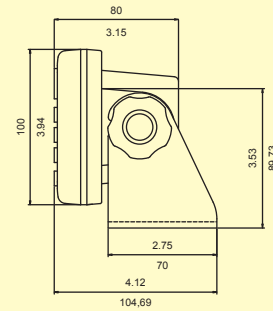

<Side>

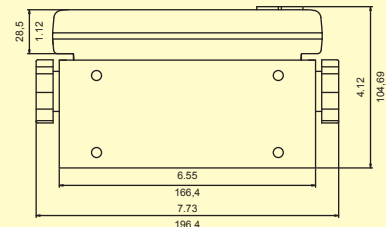

<Bottom>

*SPECIFICATIONS SUBJECT TO CHANGE WITHOUT NOTICE

Certified to ISO 9001/2000

04723H Printed in Korea

Haiyang OLIX CO., LTD.
103-903 Bucheon Technopark 364 Samcheongdong Ojeonggu
Bucheon Gyeonggi, Korea
Tel : +82 2 3240381 Fax: +82 32 3274713
Web-site: <http://www.haiyang.co.kr>
E-mail: sales@haiyang.co.kr